



ASPIRE

— TO MOVE —



Westhall Road, Bath

Four bedroom House of Multiple Occupancy available to four professional sharers or four masters/PhD students. Please note the landlord is not looking to accept undergraduate students for this property. Offered fully furnished and available from the 3rd August.

Westhall Road is a cul-de-sac of residential properties located one street away from Victoria Park. Local amenities include a convenient Tesco Express, independent shops, a cafe and several excellent pubs including The Victoria Pub Kitchen and The Hop Pole. The River Avon towpath gives a great cycle route to Bristol and Oldfield Park train station is only 0.6 miles from the front door. Local schools include St Andrews 0.8 miles, Newbridge Primary and Junior Schools 0.9 miles and WASPS 1.5 miles away.

£3,200 PCM

Westhall Road, Bath

- Video viewing available
- Fully furnished
- Council tax band C
- Four bedroom HMO
- Garden
- Available 3rd August
- Suitable for professional sharers or masters PhD students
- Assured periodic tenancy
- Holding deposit: £738

Four bedroom House of Multiple Occupancy available to four professional sharers or four masters/PhD students. Please note the landlord is not looking to accept undergraduate students for this property. Offered fully furnished and available from the 3rd August.

Westhall Road is a cul-de-sac of residential properties located one street away from Victoria Park. Local amenities include a convenient Tesco Express, independent shops, a cafe and several excellent pubs including The Victoria Pub Kitchen and The Hop Pole. The River Avon towpath gives a great cycle route to Bristol and Oldfield Park train station is only 0.6 miles from the front door. Local schools include St Andrews 0.8 miles, Newbridge Primary and Junior Schools 0.9 miles and WASPS 1.5 miles away.

The property has recently acquired a HMO (House of Multiple Occupancy licence) and is available to be rent on one contract to four professional sharers or four masters/PhD students.

Downstairs the house has dining room to the front with bay window, living room which occupies the middle of the house and kitchen to the rear. The kitchen has base and wall units, cooker, hob, fridge, freezer, dishwasher and washing machine. On the first floor there are three bedrooms and a shower room. On the top floor there is the final bedroom. Each bedroom comes fully furnished with double bed, bedside tables and option for storage.

To the rear is a garden with area laid to lawn and a patio. The property has gas central heating, please note the property is subject to on street, permit parking.

The property is available from the 3rd August to four professional sharers or four masters/PhD students.

Council tax band C: £2066.91

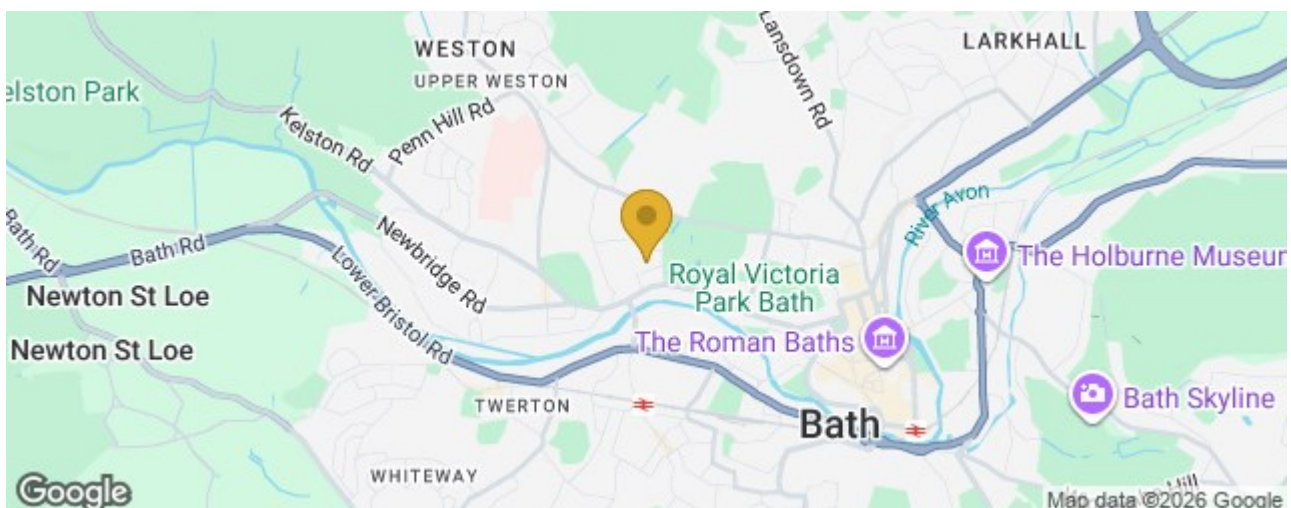



Floor Plan

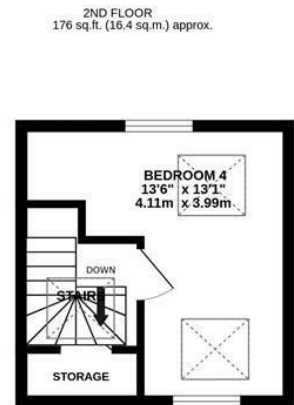
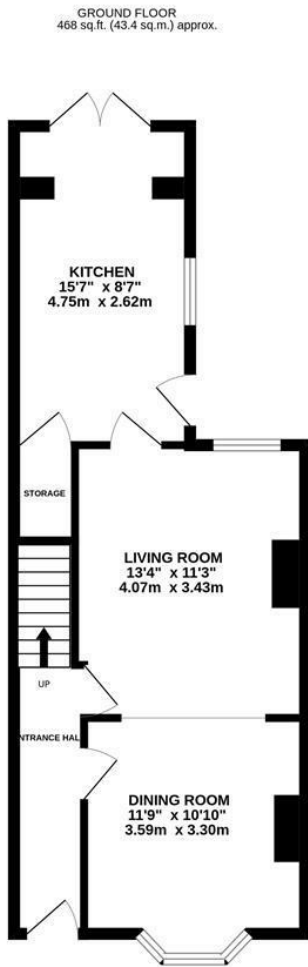

WESTHALL ROAD, BATH, BA1

TOTAL FLOOR AREA: 1085 sq.ft. (100.8 sq.m.) approx.

Whilst every attempt has been made to ensure the accuracy of the floorplan contained here, measurements of doors, windows, rooms and any other items are approximate and no responsibility is taken for any error, omission or mis-statement. This plan is for illustrative purposes only and should be used as such by any prospective purchaser. The services, systems and appliances shown have not been tested and no guarantee as to their operability or efficiency can be given.
Made with Metropix ©2023

These particulars, whilst believed to be accurate are set out as a general outline only for guidance and do not constitute any part of an offer or contract. Intending purchasers should not rely on them as statements of representation of fact, but must satisfy themselves by inspection or otherwise as to their accuracy. No person in this firm's employment has the authority to make or give any representation or warranty in respect of the property.

